



AC-941



AC-946

AC-220 SERIES

ACS Sonic Horn Acoustic Cleaners use simple modular construction. There are two basic components: A Bell for maximum output efficiency and a Sound Generator for sound production. ACS Acoustic Cleaners are pneumatically operated. Compressed air is forced over a precision-machined, titanium diaphragm, causing it to flex. This produces low frequency, high energy sound waves which are amplified by the Bell. These sound waves cause particulate deposits to dislodge, which can then be removed by gravity and / or gas flow.

ADVANTAGES:

- Low Initial Investment
- Easy Installation
- Low Installation Cost
- Low Maintenance Cost
- Low Operational Cost
- No Structural Damage
- No Mechanical Wear on Equipment Surfaces
- No Corrosion or Blockage
- Cleaning of Inaccessible Parts

APPLICATIONS	PREVENTS
Boilers	Particulate deposit build-up and increases heat transfer efficiency
Precipitators	<ul style="list-style-type: none"> • Distribution plate plugging • Collecting plate build-up • Electrode build-up • Hopper pluggage • Complete elimination of tumbling hammer rapping systems
Selective Catalytic Reduction (SCR)	<ul style="list-style-type: none"> • Deposit build-up on catalyst modules
Economizers	<ul style="list-style-type: none"> • Deposit build up on boiler tubes
Baghouses	<ul style="list-style-type: none"> • Short bag life • High pressure drop • Hopper pluggage
Hoppers / Silos	<ul style="list-style-type: none"> • Plugging • Material flow problems such as bridging and ratholing • Deposit build-up
Ductwork / Breaching	<ul style="list-style-type: none"> • Excessive fallout • Deposit build-up
Fans	<ul style="list-style-type: none"> • Out of balance conditions
Air Pre-Heaters	<ul style="list-style-type: none"> • Particulate deposit build-up and increases heat transfer efficiency

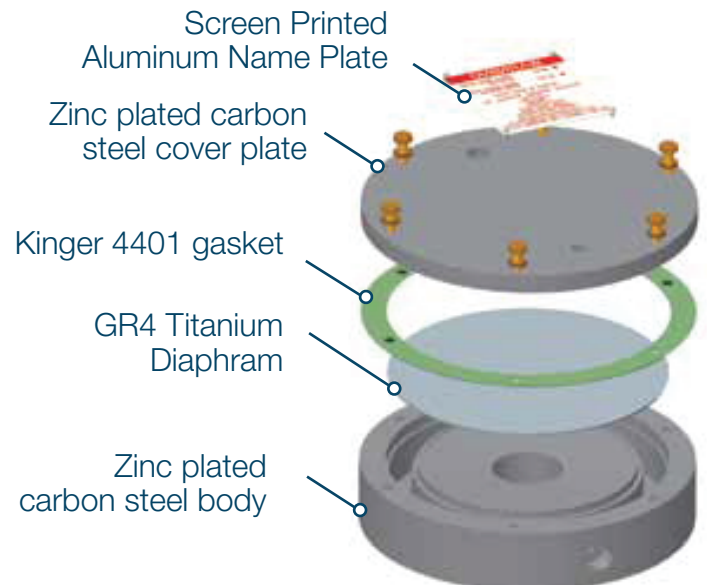

AC-220 SERIES

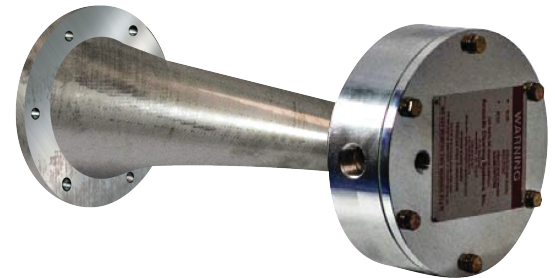
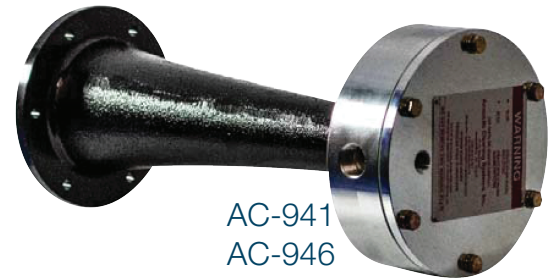
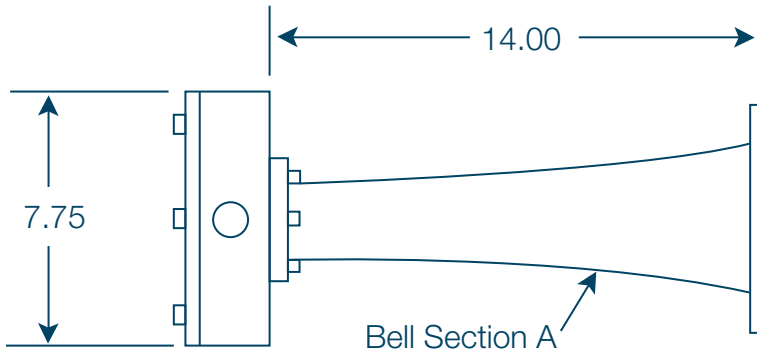

DUST COLLECTOR



SCR REACTOR



SPECIFICATIONS

Fundamental Frequency	230 Hz
Output Power Level	150 dB
Material Per Model	Bell Section A
AC-941 AC-946	Cast Iron Cast Stainless
Diaphragm Material	Titanium
Weight	36.5 - 38.5 lbs
Air Consumption	Pressure – 70-90 PSI Consumption – 70-80 SCFM